

**APT MODEL 190  
PAVING BREAKER**

1 1/8 HEXAGON x 6" - PART # 5239  
1 1/4 HEXAGON x 6" - PART # 5240

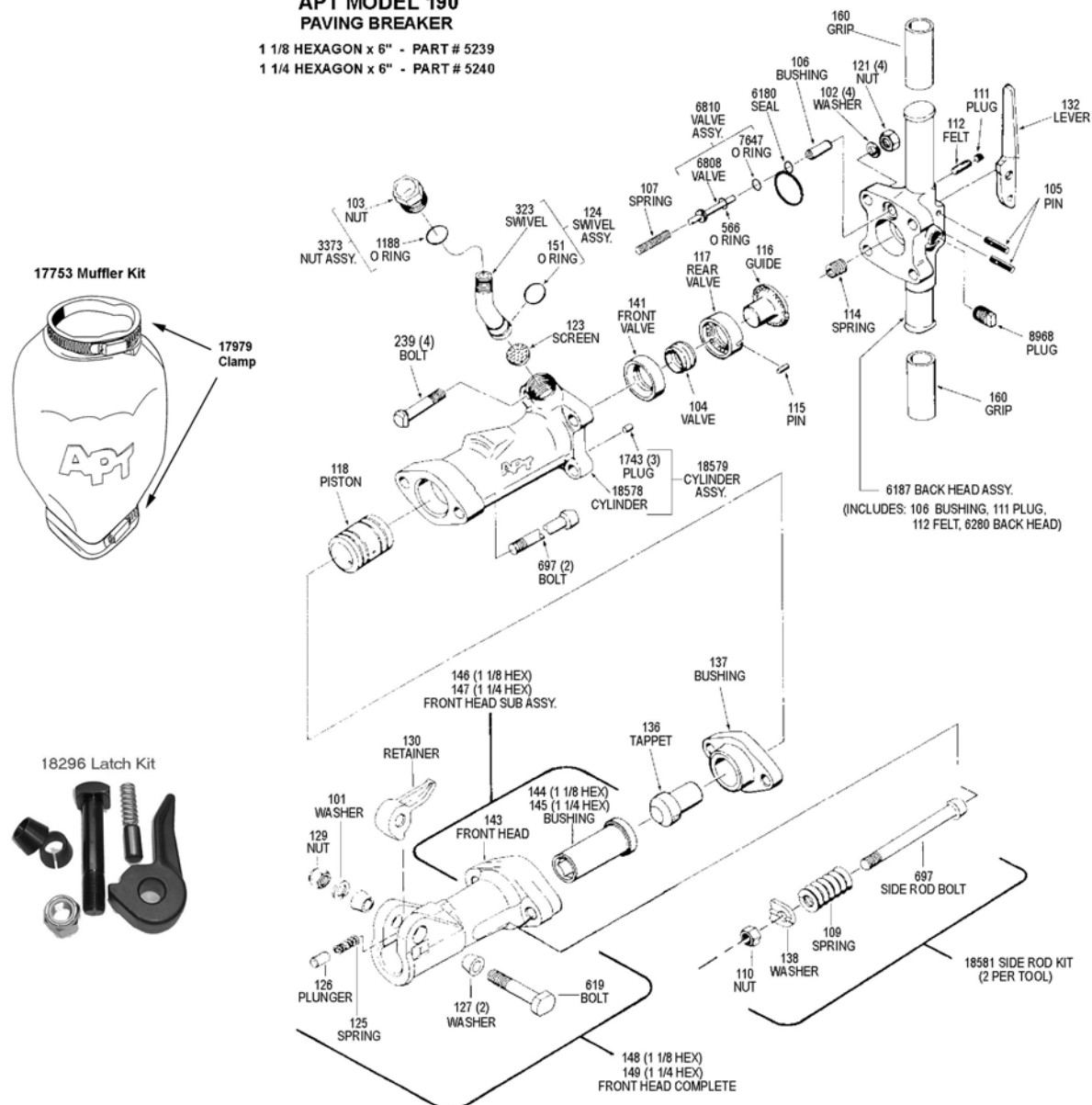

Index No	Part No	Description
1	101	LOCK-WASHER
2	102	WASHER (split lock)
3	103	NUT, AIR INLET SWIVEL
4	104	VALVE (main / auto-cycling)
5	105	PIN, ROLL
6	106	BUSHING, TV
7	109-APT	SPRING (front head / side rod)
8	110-APT	NUT (fronthead bolt)
9	111	PLUG, DRY SEAL, PRESSURE
10	112-APT	FELT, OIL CONTROL
11	114-APT	SPRING, PLUNGER
12	115-APT	PIN, DOWEL
13	116-APT	VALVE, GUIDE
14	117-APT	VALVE, CHEST-REAR
15	118-APT	PISTON (APT-180 & 190)
16	1188-APT	ORING (swivel nut, APT-180, 190)
17	121-APT	NUT (hex)
18	123-APT	SCREEN
19	124-APT	PIPE (air inlet swivel with oring)

**Manufacturer: American Pneumatic****Model: APT-190**

20	125-APT	SPRING, PLUNGER
21	126-APT	PLUNGER
22	127-APT	CONE-RUBBER
23	129-APT	NUT, ELASTIC STOP
24	130-APT	LATCH (steel retainer)
25	132-APT	LEVER, THROTTLE
26	136-APT	TAPPET (APT-190)
27	137-APT	BUSHING (tappet seat, APT-190)
28	138	LOCKWASHER (fronthead bolt)
29	141-APT	VALVE, CHEST-FRONT
30	143-APT	REPL BY: 146 OR 147
31	144-APT	BUSHING. 1-1/8in HEXAGON
32	145-APT	BUSHING, 1-1/4in HEXAGON
33	146-APT	FH (APT-190, W/ 1-1/8in hex )
34	147-APT	FH (APT-190, w/ 1-1/4in hex)
35	148-APT	FH COMPLETE (APT-190, 1-1/8in)
36	149	FH COMPLETE (APT-190, 90lb 1-1/4in)
37	151-APT	ORING (swivel pipe, APT-180, 190)
38	160-APT	GRIP, HANDLE
39	1743-APT	PLUG, 5/8in DIAMETER
40	18296	LATCH KIT (APT160, 180)
41	18579	CYLINDER, 190
42	18581	SIDE ROD KIT (190)
43	239	BOLT (backhead, APT 160, 180, 190)
44	323-APT	SWIVEL
45	3373-APT	NUT (air inlet swivel with oring)
46	566-APT	ORING (tv stem)
47	6180	SEAL (90LB)
48	6187-APT	BACKHEAD ASSY
49	619-APT	BOLT-RETAINER
50	6810-APT	THROTTLE VALVE (3364)
51	697-APT	BOLT
52	7647	ORING (tv seat - APT 160, 180, 190)
53	8968	PLUG, OIL
54	17753	MUFFLER, APT 90lb
55	17979	MUFFLER CLAMP